

SINGLE PUMP SAFETY SWITCHGEAR

The need to use the same vacuum pump in various spots in the work environment, such as, for example, a shipyard, has led us to creating this mobile switchgear that allows for polarity reversal in presence of current, as well as for time setting pump operation and the automatic start-up restoration in case of accidental black-out.

The switchgear is enclosed in a special watertight metal casing and it is composed of fuses, remote control switches with thermal protection, a transformer for low voltage auxiliary command power supply.

On the casing lid, on the other hand there are installed:

- A line switch with indicator light;
- A change-over switch for pump start-up with indicator light;
- A change-over switch for polarity reversal;
- An emergency button;
- A timer for setting the duration of pump operation;
- An hour-counter for counting the actual pump operation time;
- A malfunction warning light.

This switchgear is available in two versions: the first one managing a vacuum pump with a power up to Kw and the second one a vacuum pump with a power ranging from 4 to 7.5 Kw.

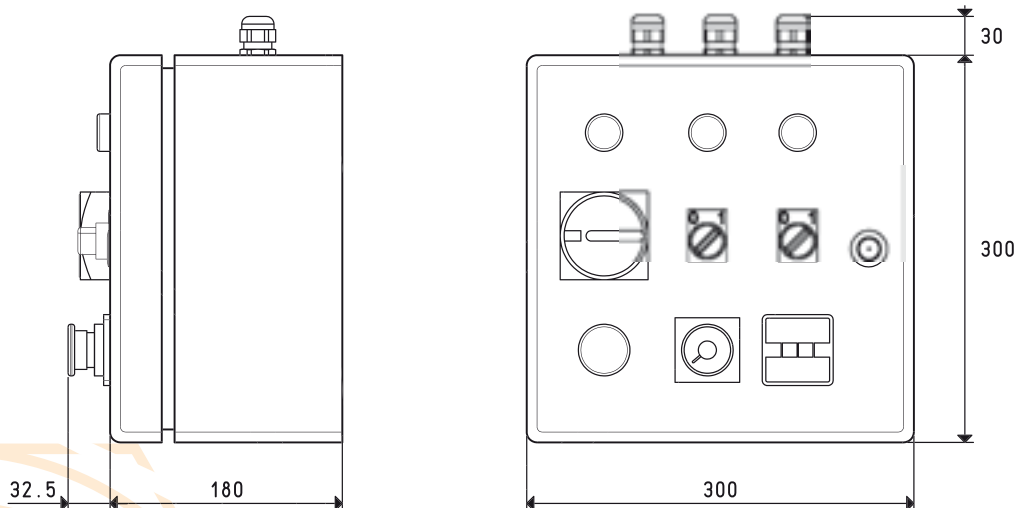

3D drawings available at www.vuototecnica.net

Art.	Number of pumps n°	Motor execution Volt	Pump	Weight
			max. power Kw	
DO 100 93	1	3 ~ 230/400-50Hz	3.0	8.0
DO 100 94	1	3 ~ 230/400-50Hz	7.5	8.0