

SMALL PNEUMATIC BLOWING PUMPS PS 10, PS 14 and PS 18

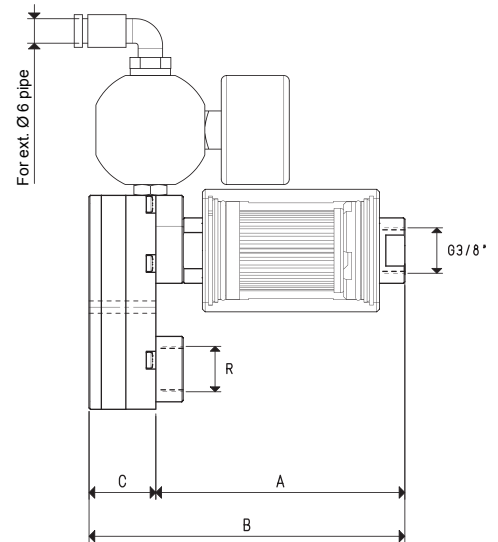
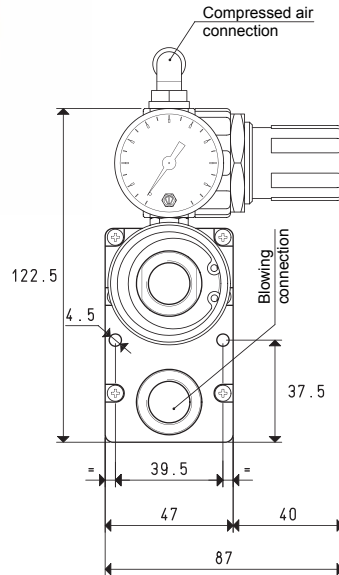
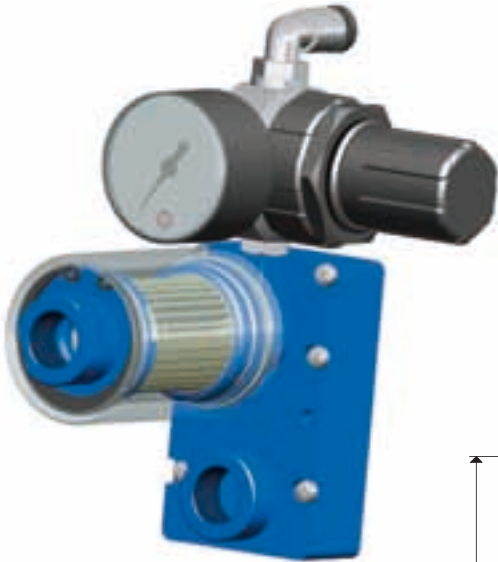

Art.		PS 10				
Supply pressure	bar (g)	1	2	3	4	5
Max. blowing pressure	-KPa	0.1	0.2	0.3	0.5	0.7
Air consumption	NI/s	0.5	0.9	1.2	1.6	1.9
Quantity of blown air	cum/h	5.8	9.2	12.0	14.2	16.2
A				94		
B				118.5		
C				24.5		
R				G3/8"		
Weight	Kg			0.49		
Art.		PS 14				
Supply pressure	bar (g)	1	2	3	4	5
Max. blowing pressure	-KPa	0.1	0.2	0.3	0.5	0.7
Air consumption	NI/s	0.9	1.3	1.7	2.1	2.5
Quantity of blown air	cum/h	9.2	12.6	16.3	19.0	21.6
A				94		
B				118.5		
C				24.5		
R				G3/8"		
Weight	Kg			0.50		
Working temperature		PS 18				
Supply pressure	bar (g)	1	2	3	4	5
Max. blowing pressure	-KPa	0.1	0.2	0.3	0.5	0.7
Air consumption	NI/s	1.2	1.7	2.3	2.9	3.6
Quantity of blown air	cum/h	12.3	17.6	23.0	26.9	31.0
A				94		
B				128.5		
C				34.5		
R				G1/2"		
Weight	Kg			0.52		
Working temperature	°C			-20 / +80		

Note: All the values in the table are valid at a normal atmospheric pressure of 1013 mbar and obtained with a constant supply pressure.

Conversion ratio: inch = $\frac{\text{mm}}{25.4}$; pounds = $\frac{\text{g}}{453.6} = \frac{\text{Kg}}{0.4536}$

GAS-NPT thread adapters available at page 1.117