

SUPPORTS

Art.	A Ø	B Ø	C Ø	D Ø	E	H	Support material	Cup art.	Weight g
00 08 280	35	G1/2"	--	70	12.5	22.5	aluminium	01 150 55	120
00 08 281	65	G1/2"	--	130	12.5	23.5	aluminium	01 210 60	465
00 08 286	35	--	8	70	12.5	22.5	aluminium	01 150 55	125
00 08 287	65	--	8	130	12.5	23.5	aluminium	01 210 60	470



GAS - NPT ADAPTERS

These adapters allow using NPT threaded fittings on vacuum components with gas threads, such as cups, valves and solenoid valves, filters etc.

FEMALE GAS - MALE NPT ADAPTER

Art.	A Ø	D Ø	E	F	H	T	Adapter material	Weight g
00 08 259	1/8" NPT	G1/8"	10	12	22	14	brass	10
00 08 260	1/4" NPT	G1/4"	12	17	29	19	brass	15
00 08 261	3/8" NPT	G3/8"	16	18	34	22	brass	28
00 08 262	1/2" NPT	G1/2"	17	19	36	27	brass	47
00 08 263	3/4" NPT	G3/4"	19	20	39	32	brass	60
00 08 264	1" NPT	G1"	22	20	42	41	brass	92
00 08 265	1" 1/4 NPT	G1" 1/4	23	23	46	50	brass	132
00 08 266	1" 1/2 NPT	G1" 1/2	23	23	46	60	brass	200
00 08 267	2" NPT	G2"	25	24	49	70	brass	277

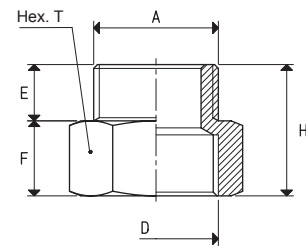

MALE GAS - FEMALE NPT ADAPTER

Art.	A Ø	D Ø	E	F	H	T	Adapter material	Weight g
00 08 268	G1/8"	1/8" NPT	10	15	25	14	brass	10
00 08 269	G1/4"	1/4" NPT	11	17	28	19	brass	15
00 08 270	G3/8"	3/8" NPT	12	22	34	22	brass	28
00 08 271	G1/2"	1/2" NPT	14	23	37	27	brass	47
00 08 272	G3/4"	3/4" NPT	14	24	38	32	brass	60
00 08 273	G1"	1" NPT	17	28	45	41	brass	92
00 08 274	G1" 1/4	1" 1/4 NPT	18	28	46	50	brass	132
00 08 275	G1" 1/2	1" 1/2 NPT	19	29	48	60	brass	200
00 08 276	G2"	2" NPT	20	31	51	70	brass	277

