

[Basic cup holders with plunger valve]

They have the same mechanical features as the basic cup holders but are inclusive of a plunger valve, integral to a conical valve, which allows to produce vacuum in the cup only when it is in contact with the load to be lifted.

They are available for different cup diameters and, upon request, they can be made with stainless materials.

N.B.

Cups are not included in the following part numbers of the cup holder and therefore, they must be ordered separately.

The real strokes are:

C = 28	mm 16
C = 65	mm 49
C = 95	mm 74

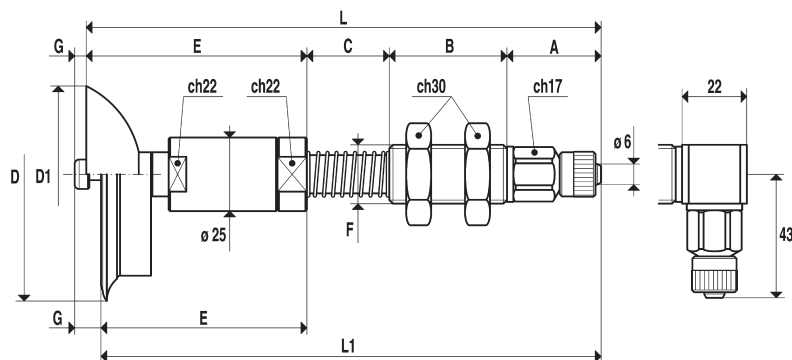

Cup holder with rapid straight fitting for plastic hose $\varnothing 6 \times 8$

Art.	Force Kg.	A	B	*C	D \varnothing	D1 \varnothing	E	F \varnothing	G	L	L1	Art. Cup
03 45 10	3.98	32	40	28	--	45	70	M20	2	170	---	01 45 10
03 60 10	7.06	32	40	28	--	60	72	M20	2	172	---	01 60 10
03 65 15	8.29	32	40	28	65	--	70	M20	2	---	170	01 65 15
03 80 20	12.56	32	40	28	80	--	73	M20	3	---	173	01 80 20
03 85 10	14.18	32	40	28	--	85	92	M20	3	192	---	01 85 10
03 85 15	14.18	32	40	28	85	--	70	M20	2	---	170	01 85 15
03110 10	23.74	32	40	28	114	--	70	M20	2	---	170	01110 10

N.B. - L-type fitting is supplied only upon request. * Available also with size "C" mm. 65 and mm. 95.