

[Special cup holders]

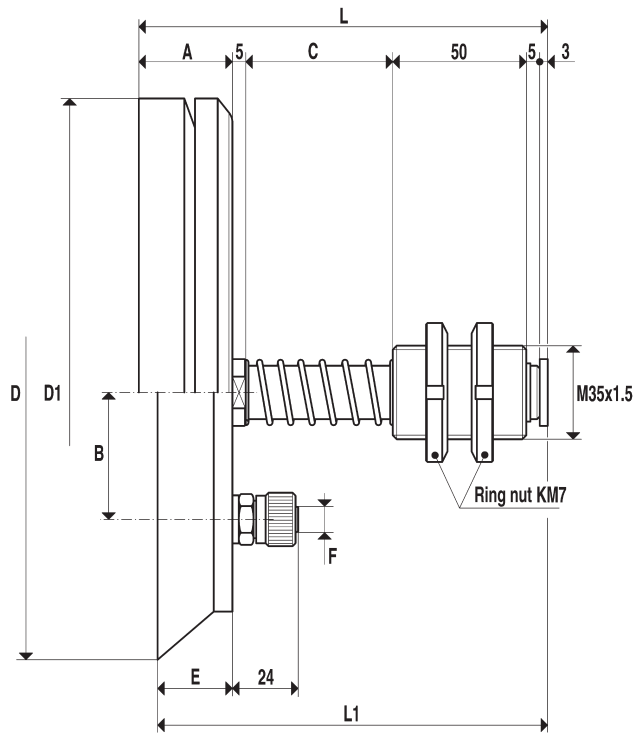

Developed for lifting heavy bodies and to support hard and continuous duties in particularly dusty or damp environments, the special cup holders of this series consist of:

- A chromium plated steel stem for the fastening of the cup.
- A brass threaded support, with self-lubricating bushes, supplied with two ring nuts for fastening the cup holder to the machine.
- A spring to cushion the impact of the cup with the load to be lifted.
- A special cup, that can be supplied in different diameters and compounds, to be specified when ordering.

N.B.

Cups are not included in the following part numbers of the cup holder and therefore, they must be ordered separately.

The real strokes are:

C = 55	mm 37
C = 110	mm 84

Cup holder with rapid straight fitting for plastic hose

Art.	Force Kg.	A	B	*C	D Ø	D1 Ø	E	F Ø	L	L1	Art. Cup
06 150 15	45.0	--	40.0	55	150	---	26	9	---	144	08 150 15
06 200 10	78.5	--	47.5	55	200	---	28	9	---	146	08 200 10
06 220 10N	63.6	35	70.0	55	---	220	--	9	153	---	01 220 10N
06 220 10A	78.5	21	70.0	55	---	220	--	9	139	---	01 220 10A
06 250 10	122.6	--	72.5	55	250	---	28	9	---	146	08 250 10
06 300 10	176.6	--	89.0	55	300	---	31	16	---	149	08 300 10
06 350 10	240.0	--	89.0	55	350	---	31	16	---	149	08 350 10

* Available also with size "C" mm. 110.