

[Special articulated compact stroke cup holders]

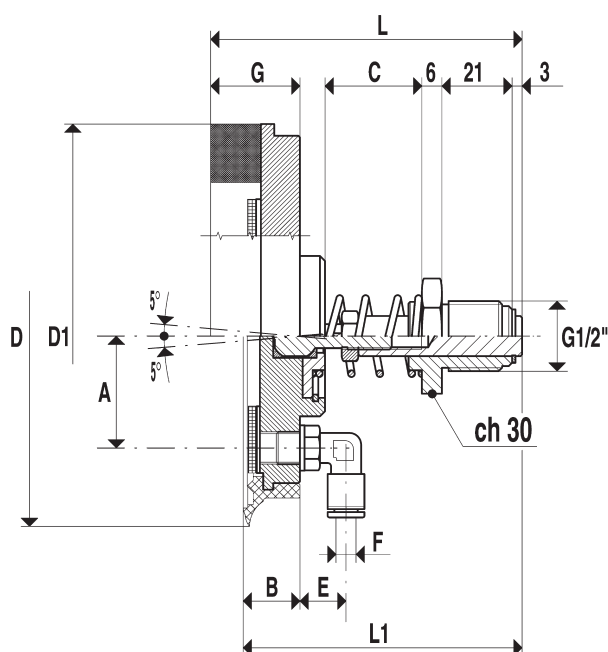

Cup holder with rapid L-fitting for plastic hose

Art.	Force Kg.	A	B	C	D Ø	D1 Ø	E	F Ø	G	L	L1	Art. Cup
06 110 42	23.74	33.5	17	29	114	--	13.0	6	--	--	83.5	01 110 10
06 127 42	17.50	33.5	--	29	--	127	13.5	8	26.7	93.2	--	01 127 15
06 150 42	45.00	43.5	23	29	154	--	13.0	6	--	--	89.5	01 150 10

Generally, the handling of glass and marble slabs is achieved using vacuum cups, which pick up from a horizontal surface and then pivot the load them vertically or vice-versa.

These special articulated cup holders with a shorter stroke have been developed to minimize the lever forces exerted during this action, which develops between the cup and the fixing bush of the machine during the slabs rotation.

They have all the specifications of the special cup holders previously described, but with very small sizes, achieved by making the seat of the articulated joint out of the cup support.

This reduces the length of the steel stem and spring stroke and by modifying the brass bush to allow connection directly to the machine.

The cup incorporates a special anti-slip surface that prevents the load from slipping during the lift cycle.

N.B.

Cups are not included in the following part numbers of the cup holder and therefore, they must be ordered separately.