

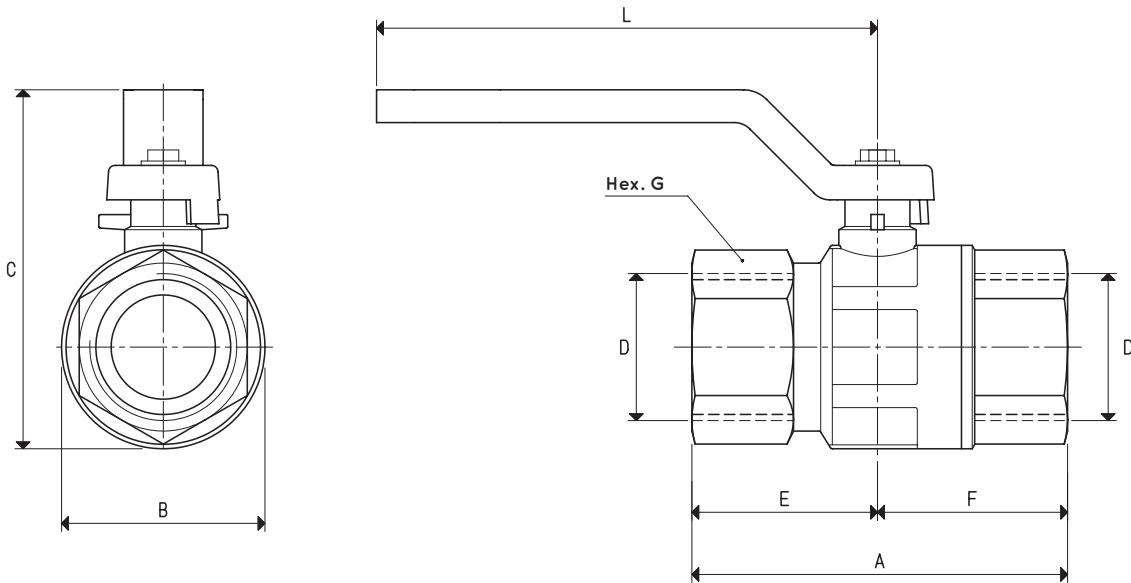

## MANUAL 2-WAY AND 3-WAY VACUUM VALVES

These manual valves are used for intercepting vacuum in all those plants where solenoid valves cannot be installed. They feature a die-cast nickel-plated brass body, a chromed brass ball shutter and Teflon® seals to guarantee perfect seal even at high temperatures. A lever on the ball shutter, manually rotated 90°, allows opening or closing the valve precisely and with no effort.

3D drawings are available on [vuotecnica.net](http://vuotecnica.net)



### 2-WAY MANUAL VALVES

Item	A	B	C	D Ø	Mouth Ø	E	F	G	L	Weight Kg
<b>13 01 10</b>	49	23	48	G1/4"	10	24	25	18	80	0.13
<b>13 02 10</b>	52	23	56	G3/8"	10	23	29	20	80	0.13
<b>13 03 10</b>	61	30	63	G1/2"	15	30	31	25	88	0.21
<b>13 04 10</b>	68	36	72	G3/4"	20	33	35	31	114	0.32
<b>13 05 10</b>	85	44	80	G1"	25	42	43	38	113	0.47
<b>13 06 10</b>	99	57	105	G1" 1/4	32	50	49	47	137	0.74
<b>13 07 10</b>	109	70	126	G1" 1/2	40	55	54	54	156	1.26
<b>13 08 10</b>	130	83	135	G2"	50	62	68	66	156	1.77
<b>13 09 10</b>	168	140	210	G3"	75	84	84	99	246	7.09